



# Spring Fling



by Laura Jones



57" x 68"



Featuring fabrics from the **BLOOM** collection by CPdesigns for **STUDIO·e·fabrics**

## Materials

E60-1439-GRY	1 Yard	E60-1445-PUR	1/2 Yard
E60-1440-PUR	1 1/4 Yards	E60-1445-GRN	3/8 Yard
E60-1441-PUR	1/4 Yard	E60-1445-TURQ	1/4 Yard
E60-1442-GRN	1/4 Yard	Backing fabric	4 Yards
E60-1443-TURQ	1/4 Yard	Batting	65" x 76"
E60-1444-PUR	1/4 Yard	Fusible web	2 Yards
E60-1444-GRY (includes binding)	2 Yards	Coordinating thread	



E60-1439-GRY  
(Fabric A)

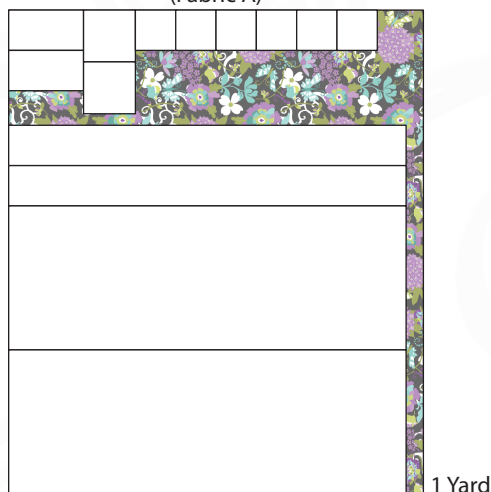

- Cut 2 - 3 1/2" x 6 1/2" (Block 4)
- Cut 2 - 4 1/2" x 4 1/2" (Stacked Squares)
- Cut 6 - 3 1/2" x 3 1/2" (Blocks 1, 2)
- Cut 2 - 3 1/2" x 34 1/2"
- Cut 2 - 12 1/2" x 34 1/2"

E60-1441-PUR  
(Fabric B)

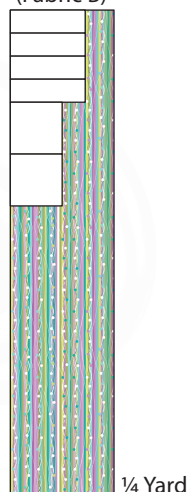

- Cut 4 - 2" x 6 1/2" (Block 1)
- Cut 2 - 4 1/2" x 4 1/2" (Stacked Squares)

E60-1442-GRN  
(Fabric C)

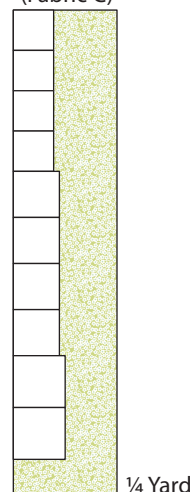

- Cut 4 - 3 1/2" x 3 1/2" (Block 3)
- Cut 2 - 4" x 4" (Block 1)
- Cut 2 - 4" x 4" (Block 3)
- Cut 2 - 4 1/2" x 4 1/2" (Stacked Squares)

E60-1443-TURQ  
(Fabric D)

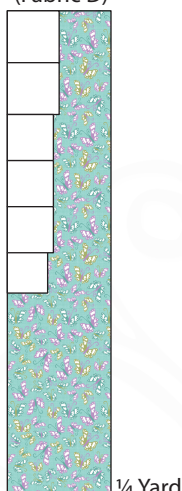

- Cut 2 - 4 1/2" x 4 1/2" (Stacked Squares)
- Cut 3 - 4" x 4" (Block 5)
- Cut 1 - 3 1/2" x 3 1/2" (Block 5)

E60-1440-PUR  
(Fabric E)

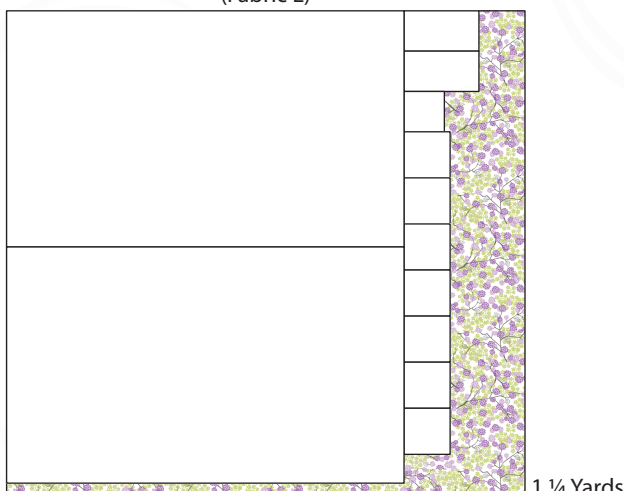

- Cut 2 - 20 1/2" x 34 1/2"
- Cut 2 - 3 1/2" x 6 1/2" (Block 4)
- Cut 1 - 3 1/2" x 3 1/2" (Block 5)
- Cut 7 - 4" x 4" (Blocks 3, 4, 5)

E60-1445-PUR  
(Fabric F)

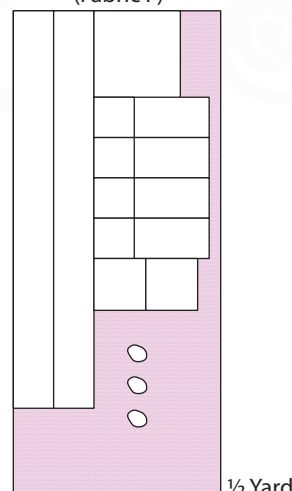

- Cut 2 - 3 1/2" x 34 1/2"
- Cut 4 - 3 1/2" x 3 1/2" (Block 4)
- Cut 4 - 3 1/2" x 6 1/2" (Block 2)
- Cut 2 - 4 1/2" x 4 1/2" (Stacked Squares)
- Cut 1 - 7 1/2" x 7 1/2" (Block 4)
- Appliqué Shapes (wait to cut later in fusible appliqué step)



*Continued on page 3...*

*Cutting continued...*



E60-1445-TURQ  
(Fabric G)

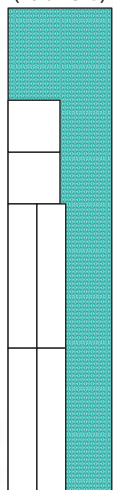

¼ Yard

Cut 4 - 2 ½" x 12 ½"  
Cut 2 - 4 ½" x 4 ½"  
(Stacked Squares)

E60-1445-GRN  
(Fabric H)

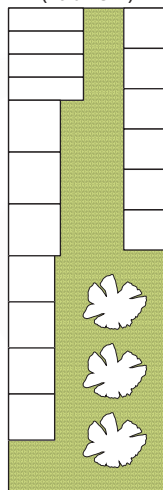

⅜ Yard

Cut 4 - 2" x 6 ½" (Block 1)  
Cut 3 - 4 ½" x 4 ½"  
(Stacked Squares)  
Cut 4 - 4" x 4" (Blocks 3, 4)  
Cut 6 - 3 ½" x 3 ½" (Blocks 2, 3)  
Appliqué Shapes (wait to cut  
later in fusible appliqué step)

E60-1444-PUR  
(Fabric I)

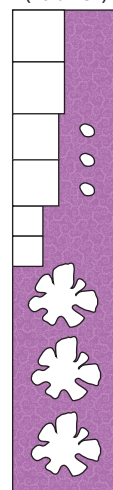

¼ Yard

Cut 2 - 4 ½" x 4 ½"  
(Stacked Squares)  
Cut 2 - 4" x 4" (Block 2)  
Cut 2 - 2 ⅝" x 2 ⅝" (Block 1)  
Appliqué Shapes (wait to cut  
later in fusible appliqué step)

E60-1444-GRY  
(Fabric J)

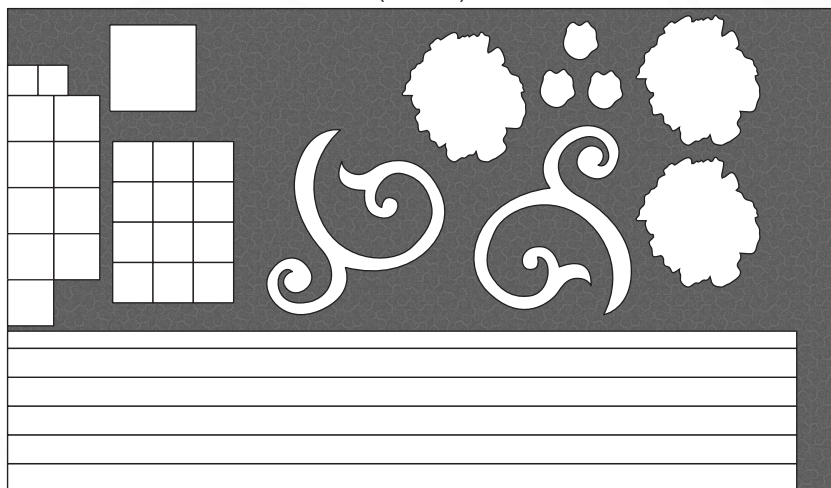

2 Yards

Cut 2 - 2 ⅝" x 2 ⅝" (Block 1)  
Cut 9 - 4" x 4" (Blocks 2, 3, 5)  
Cut 1 - 7 ½" x 7 ½" (Block 4)  
Cut 12 - 3 ½" x 3 ½" (Blocks 2, 5)  
Cut 1 - 1 ½" x 68 ½"  
Cut 1 - 2 ½" x 68 ½"  
Cut 4 - 2 ½" x 68 ½" (binding)  
Appliqué Shapes (wait to cut later in fusible appliqué step)





## Instructions

Read all instructions before beginning project. Use a  $\frac{1}{4}$ " seam allowance and stitch with fabric right sides together unless noted otherwise. Press the seams as shown by the arrows.

### 5 Vertical Block Column



Block 1

**Block 1:** Create the center section by sewing the Fabric I and J  $2\frac{5}{8}$ " squares together as shown. Stitch the Fabric C triangles cut from the 4" squares to opposite sides of the square unit, then the top and bottom, pressing seams toward the triangles. Trim points and square unit to  $6\frac{1}{2}$ ".

Create side bars by stitching the  $2" \times 6\frac{1}{2}"$  Fabric B and H rectangles together into four sets. Add them to the opposite sides of the center unit, pressing seams toward the side bars.

Add the  $3\frac{1}{2}"$  Fabric A squares to each end of the remaining side bars, pressing seams toward the side bars. Match and pin seams and stitch to the top and bottom of the block. Completed block should measure  $12\frac{1}{2}"$  square.

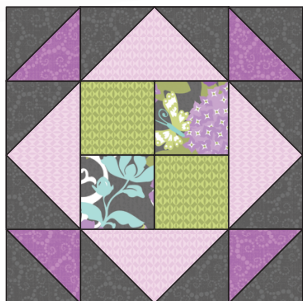
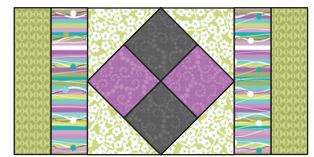
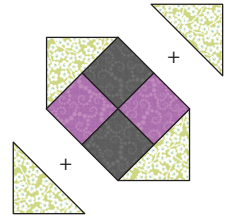

Block 2



Four-patch center

**Block 2:** Make the four-patch center section in the same manner as Block 1 using the  $3\frac{1}{2}"$  squares of Fabrics A and H. Finished unit should measure  $6\frac{1}{2}"$ .

Make four Flying Geese Units using the four Fabric F  $3\frac{1}{2}" \times 6\frac{1}{2}"$  rectangles and the eight Fabric J  $3\frac{1}{2}"$  squares. Draw a diagonal line on the wrong side of the Fabric J squares. Place a square at one end as shown and stitch on top of the line. Open and press as shown. Fold back and trim the remaining layers  $\frac{1}{4}"$  from the seam. Open triangle. Place the second square on the opposite end and repeat previous steps. Finished Flying Geese Unit should measure  $3\frac{1}{2}" \times 6\frac{1}{2}"$ . Repeat to make four units.

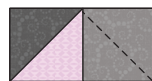
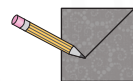

Flying Geese Unit



Make 4

The remaining squares are Half-Square Triangle Units created from the two 4" squares of Fabrics I and J. Draw a diagonal line on the wrong side of the Fabric J squares. Layer right sides together with a Fabric I square and stitch  $\frac{1}{4}"$  away from the line on both sides. Cut on the drawn line, open and press seam toward Fabric I. Square to  $3\frac{1}{2}"$ . Make four.

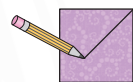

Half-Square Triangle Unit

Make 4

Lay out the units as shown and sew two Flying Geese Units to opposite sides of the center square. Press seams toward the Flying Geese Units. Attach a Half-Square Triangle Unit to each end of a Flying Geese Unit and press seam toward the Flying Geese Unit. Match seams, pin and sew to the top and bottom of the center unit as shown. Completed block should measure  $12\frac{1}{2}"$  square.

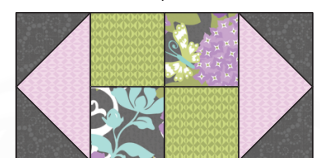
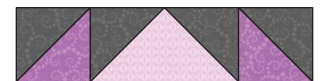

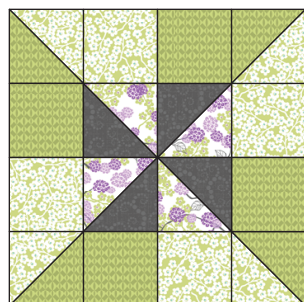

Block 3

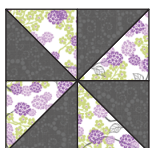

Center Pinwheel

**Block 3:** Make the center Pinwheel Unit by creating four Half-Square Triangle Units from the 4" squares of Fabrics E and J. Use the same method described for Block 2 on previous page. Completed squares should measure 3 1/2" square. Stitch together as shown for a 6 1/2" square center Pinwheel Unit. Press seams toward Fabric J.

Make four Two-Square Units using the 3 1/2" squares of Fabrics C and H. Press seams toward Fabric C. Match seams, pin and sew to opposite sides of the center unit. Press seams toward the Two-Square Units.

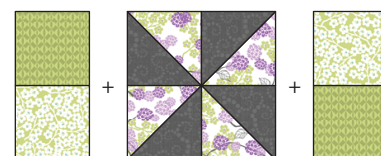

Make Half-Square Triangle Units created from two Fabric H 4" squares and two Fabric C 4" squares. Sew to opposite ends of the two-square unit and press seams toward the center unit. Match seams, pin and sew to the top and bottom of the block as shown. Press seams toward the sides. Completed block should measure 12 1/2".



Block 4

**Block 4:** Layer the two 7 1/2" Fabric F and J squares. Draw a diagonal line on the wrong side of the lighter fabric and stitch 1/4" from each side of the line. Cut apart on the line and press the seam toward the darkest fabric. Cut each square in half along the diagonal; using one triangle from each square, piece together as shown. Press seam to one side. Evenly trim square to be 6 1/2" x 6 1/2".

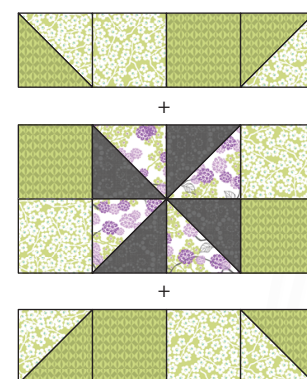

Make two Flying Geese Units using the two Fabric E 3 1/2" x 6 1/2" rectangles and the four Fabric F 3 1/2" squares. Draw a diagonal line on the wrong side of the Fabric F squares.

Place a square at one end as shown and stitch on top of the line. Open and press as shown. Fold back and trim the remaining layers 1/4" from the seam. Open triangle. Place the second square on the opposite end and repeat previous steps. Finished Flying Geese Unit should measure 3 1/2" x 6 1/2". Repeat to make two units. Sew to opposite sides of the center block as shown and press seams toward the Flying Geese Units.

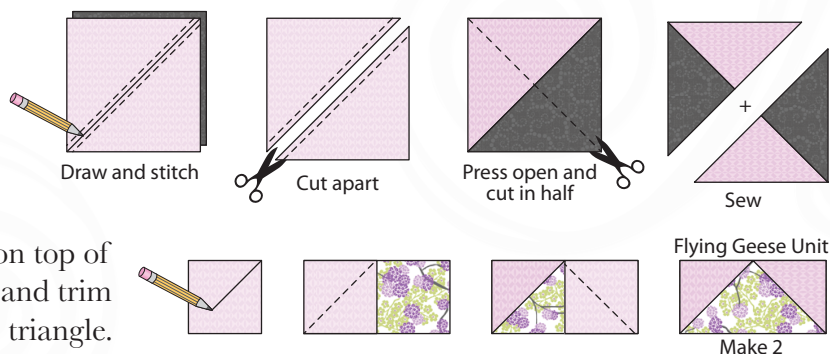

Make four Half-Square Triangle Units created from the two 4" squares of Fabrics E and H.

Draw a diagonal line on the wrong side of the Fabric E squares. Layer right sides together with a Fabric H square and stitch 1/4" away from the line on both sides. Cut on the drawn line, open and press seam toward Fabric H. Square to 3 1/2". Make four. Sew to opposite ends of the Fabric A 3 1/2" x 6 1/2" rectangles and press seams toward the rectangles.

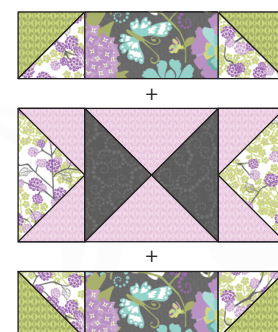
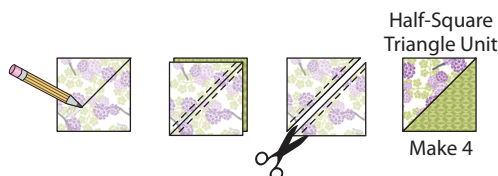

Matching seams, pin the three rows together as shown and stitch. Press seams in either direction. Completed block should measure 12 1/2".



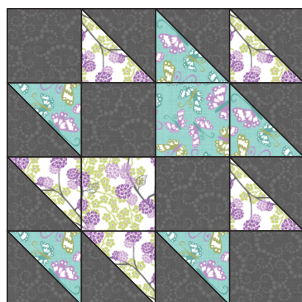

Block 5

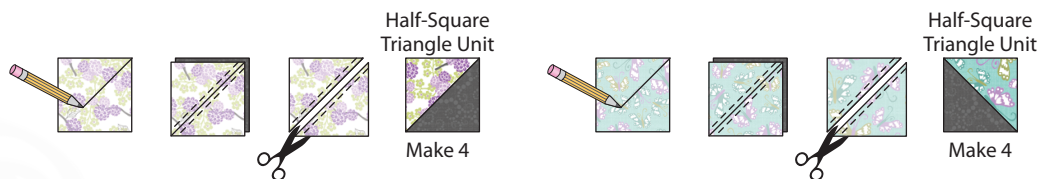

**Block 5:** Make Half-Square Triangle Units again, created from each 4" squares of Fabrics D, E and J. Draw a diagonal line on the wrong side of the Fabric D and E squares. Layer right sides together with Fabric J squares and stitch  $\frac{1}{4}$ " away from the line on both sides. Cut on the drawn line, open and press seam toward Fabric J. Square to 3  $\frac{1}{2}$ ". Make five E/J and five D/J combinations. Gather 3  $\frac{1}{2}$ " fabric D, E, and J squares, lay out the pieces as shown, and stitch each quarter together. Completed block should measure 12  $\frac{1}{2}$ ".

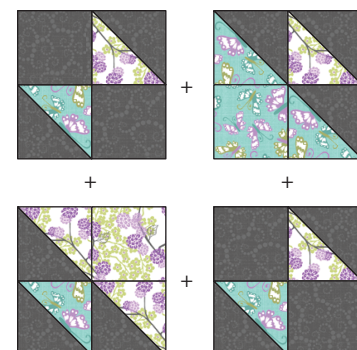

Pin and sew Fabric G 2  $\frac{1}{2}$ " x 12  $\frac{1}{2}$ " sashing strips to the blocks as shown, then assemble the entire column. Press seams toward the sashing strips.

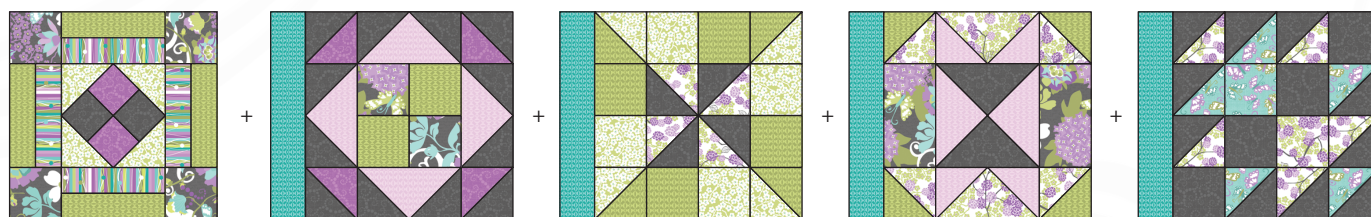

## Stacked Squares Column

Gather together the 17 - 4  $\frac{1}{2}$ " x 4  $\frac{1}{2}$ " squares and sew together as shown. Press seams in one direction.



## Flower/Scroll Appliqué Column

### Prepare the Appliqué Pieces

Enlarge and trace all flower and scroll shapes from the template sheet onto paper side of fusible web. Cut out shapes  $\frac{1}{8}$ " from drawn line. To reduce the amount of fusible web being layered on top of each other, cut out the center of each flower shape, leaving  $\frac{1}{4}$ " of fusible around the edges. Reference the cutting diagrams for correct placement of shapes to fabric. Following manufacturer's instructions, fuse pieces to **WRONG** side of fabrics. Cut out each piece along the drawn line.



### *Placing the Appliqué*

Sew the two 20 1/2" x 34 1/2" Fabric E pieces together along the short sides. Press seam to one side. Using the center seam as a placement guide, begin layering the flower at the center point. Place the two scrolls and layered flowers as shown. Fuse everything to the background fabric. Machine appliqué around all of the raw edges using a buttonhole or satin stitch.

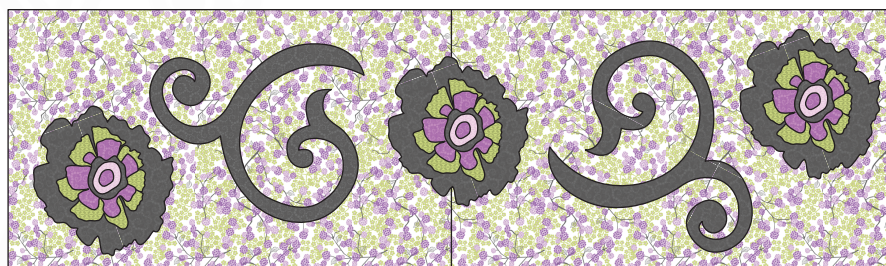

### *Assemble the Quilt Top*

Sew the pairs of 3 1/2" x 34 1/2" Fabric A and F pieces together along the short sides. Press seam to one side. Repeat with the two Fabric A 12 1/2" x 34 1/2" pieces as well. Completed lengths should measure 68 1/2". Lay out the eight columns as shown. Beginning at the left, pin and sew each column together, pressing seams as shown by the arrows. The quilt top should now measure 57" x 68".

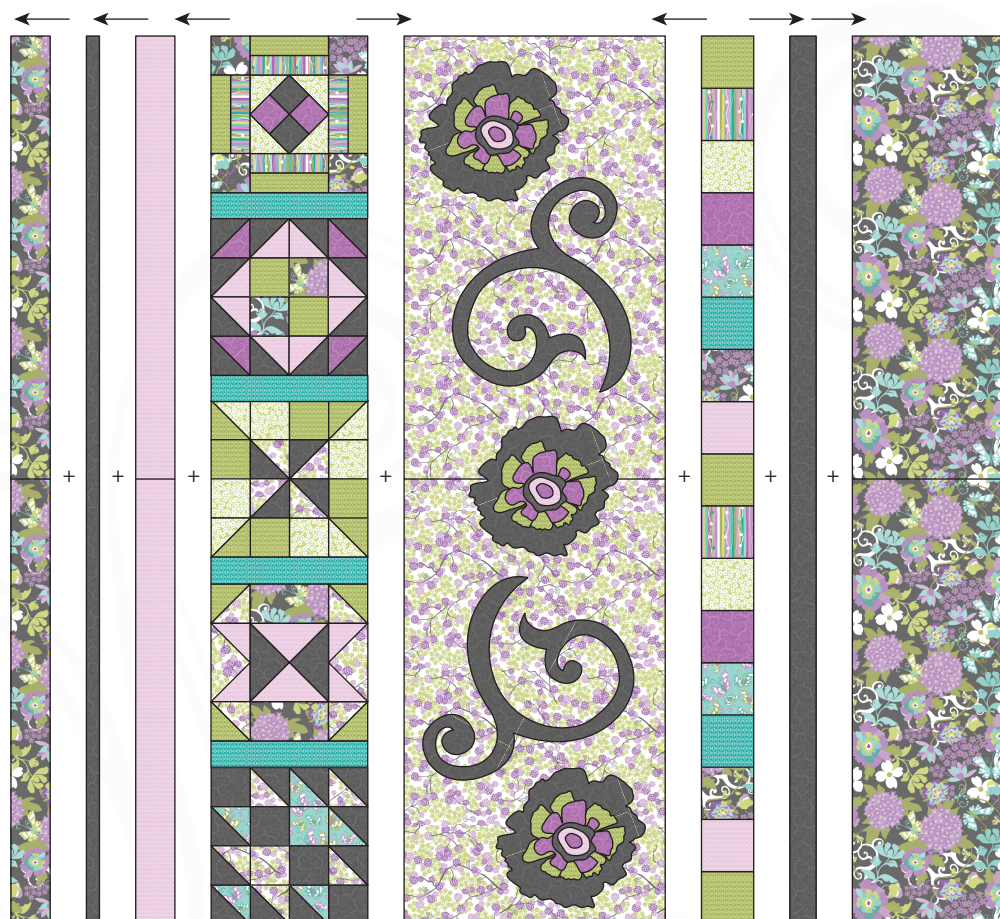



## Layering, Backing, and Quilting

Make the back by cutting the four yards into two 2-yard pieces. Trim the selvages, and sew together on the long sides. Press the seam open. Press the quilt top and backing well. Layer backing (wrong side up), batting, pressed quilt top (right side up), and baste. Quilt as desired and trim excess batting and backing when quilting is complete.

## Binding

Cut the ends of the binding strips at a 45-degree angle and sew end to end to make one continuous piece of binding. Fold in half lengthwise, and press wrong sides together. Sew the binding to the front of the quilt, raw edges together. Turn the folded edge to the back, and hand stitch in place.



**Enlarge 250% for full-scale templates.**

Trace templates onto paper side of fusible web.  
Cut out 1/8" from drawn line.



## Flower Templates (reversed)

**Trace 3 of each component**

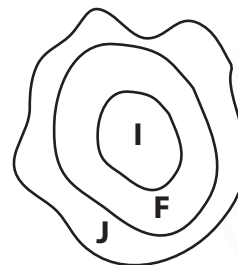
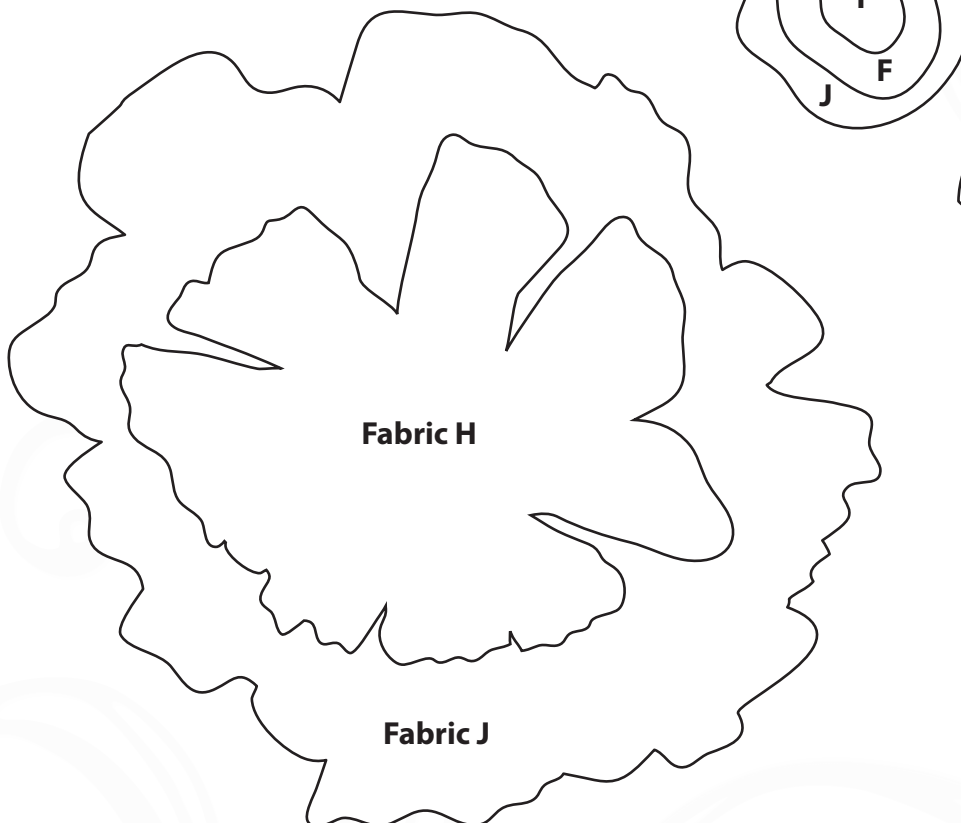





**Enlarge 250% for full-scale template.**

Trace templates onto paper side of fusible web.  
Cut out 1/8" from drawn line.

***Scroll Template (reversed)***

**Trace 2**

